

# Wireless Dynamometer



## GWD300

### DESCRIPTION

GWD300 wireless dynamometer is an extremely well-built instrument for industry use, as a standard wireless tool offer universal applications, Whether used as conventional crane weigher or to measure force, GWD300 wireless dynamometer is the latest design, compatible with the concept of portable, print and easy to operate. Shoulder bag style leather case, easy to carry, suitable for protected outdoor use, calibration is easier with 580 indicator.



### FEATURES

- Body protection :Aluminum and alloy steel capacities are powder coated .
- Accuracy :0.05% for 1-50t, 0.1% for above 50t capacity .
- Units :Units are clearly display on the screen, available in the following measurment reading: kilograms(kg), short Tons(t) pounds(lb), Newton and kilonewton(kN) .
- Shackles :High tension industrial standard G2130 anchor shackle bows, galvanized finish.
- Gravity regulation :The acceleration of gravity can be regulated through indicator according to different places value
- Functions :wireless indicator with many functions: Zero, tare, Low battery warnings, peak hold, overload warning. User calibration(with password) .
- Set-Point :Two user programmable Set-Point can be used for safety and warning applications or for limit weighing
- Package :Packed with carry case, easy to bring .
- Indicator RS-232 communication :Print or exact data easily. Continuous output can drive a scoreboard.
- Indicator key :4 local mechanical keys:“ON/OFF”,“ZERO”,“PEAK”and “Unit Change”.
- Indicator communications:Both RS232 serial port and USB port, solve most laptops without serial port problem .
- Antenna :Internal antenna ( Dimension unit : mm )
- Function on indicator keyboard :It can print data,time,Serial number, commodity number,net weight and total weight. Also can input 16 digits head information, It can store up to 2000 weighing records. It can be statistics by serial number or commodity number , also can statistics by data, statistical results can be printed with weighing number and total weight .

### SPECIFICATIONS

Body display	25mm (1'') 5digits LCD with backlight
Indicator display	25mm (1'') 5digits LCD with backlight
Power on zero range	20% F.S.
Manual zero Range	4% F.S.
Tare range	20% F.S.
Stable time	≤5 seconds
Overload indication	100% F.S. + 9e

Max. safety load	125% F.S.
Ultimate load	400% F.S.
Battery life	≥50 hours
Body battery	"LR6(AA)"size alkaline batteries. 1.5V x 3
Indicator battery	Rechargeable Ni-H battery, SC 3.5Ah
Operating temp.	- 20°C ~ + 50°C
Operating humidity	≤85% RH under 20°C
Indicator printer	FUJITSU FTP-628 MCL101#50" high speed thermal printer
Wireless distance	Min. 80m(default) [200m(optional)]
Wireless frequency	2.4GHz(default),433MHz,868MHz(optional),up to 128 channels available

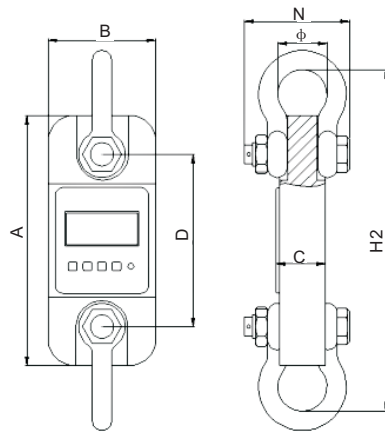

**Size Chart(mm):**

MODEL	CAP(t)	Div(kg)	A	B	C	D	φ	H	Material
GWD300-1t	1	0.5kg	245	112	37	190	43	335	Aluminum
GWD300-2t	2	1kg	260	123	37	195	51	365	Aluminum
GWD300-3t	3	1kg	260	123	37	195	51	365	Aluminum
GWD300-5t	5	2kg	285	123	57	210	58	405	Aluminum
GWD300-10t	10	5kg	320	120	57	230	92	535	Alloy Steel
GWD300-20t	20	10kg	375	128	74	260	127	660	Alloy Steel
GWD300-30t	30	10kg	420	138	82	280	146	740	Alloy Steel
GWD300-50t	50	20kg	465	150	104	305	184	930	Alloy Steel
GWD300-100t	100	50kg	570	190	132	366	229	1230	Alloy Steel
GWD300-200t	200	100kg	720	265	183	440	280	1362	Alloy Steel

**Weight:**

Model	GWD200-1t	GWD200-2t	GWD200-3t	GWD200-5t	GWD200-10t
Unit Weight(kg)	1.6	2.1	2.1	2.7	10.4
Weight with shackles(kg)	3.1	4.6	4.6	6.3	24.8
Model	GWD200-20t	GWD200-30t	GWD200-50t	GWD200-100t	GWD200-200t
Unit Weight(kg)	17.8	25	39	81	210
Weight with shackles(kg)	48.6	73	128	321	776