

# Static Torque Sensor

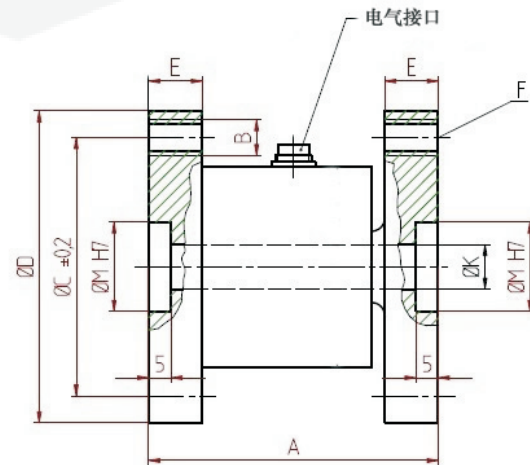

## GTS309A



Range	Size(mm)								
	A	φD	E	φM	φC	φK	S	B	F
Nm									
10K	95	205	22	135	173	40	5	M18	8x45°
20K~30K	115	245	26	155	205	50	5	M20	8x45°
40K~60K	120	280	30	200	240	60	5	M20	10x36°
100K	150	318	38	230	274	80	5	M24	10x36°

### FEATURES

- Static torque sensor, mV signal output;
- Both ends are flange connection;
- It is used to measure the torque value of static and discontinuous rotation in the middle and low ranges.

### SPECIFICATION

Range	10K~100K(Nm)		
Accuracy	±0.1%F.S · ±0.2%F.S	Compensated Temp. Range	-10~+60℃
Rated Output	1.0~1.5±0.1mV/V	Operating Temp. Range	-20~+75℃
Zero Output	±1.0%F.S	Safe Overload	150%F.S
Excitation, Recommended	5~10VDC	Ultimate Overload	200%F.S
Temp. Effect on Span	±0.03%F.S/10℃	Electrical Interface	4pin Circular Connector
Temp. Effect on Zero	±0.03%F.S/10℃	Cable	4-Wire Shielded Cable, φ5.0mm×3m
Input Resistance	750±10Ω	Material	Alloy steel
Output Resistance	700±5Ω	Ingress Protection	IP65
Insulation Resistance	≥2000MΩ/100VDC	Wiring Code	E+ : Red    E- : Black
Response Frequency	100us		S+ : Green    S- : White