

GWM203

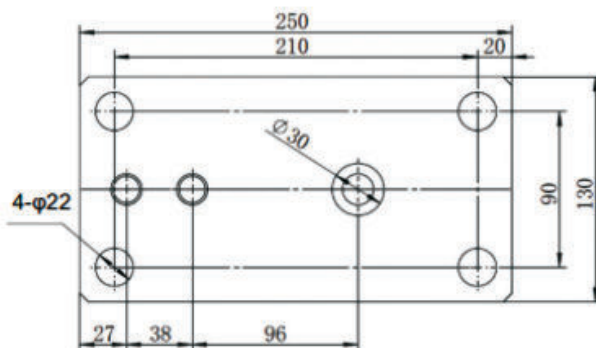
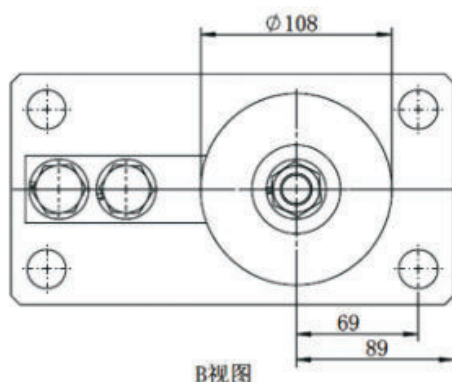
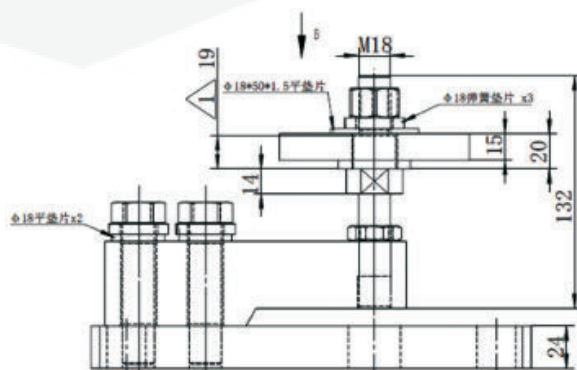

FEATURES

- Easy installation, user friendly;
- Mainly used in tower, tank, animal husbandry, etc.

SPECIFICATION

Rated Load	2, 3, 5(t)		
Comprehensive Error	±0.02%F.S	Excitation, Recommended	10VDC
Rated Output	2.0mV/V	Safe Overload	150%F.S
Zero Balance	±1.0%F.S	Ultimate Overload	200%F.S
Creep	±0.02%F.S/30min	Insulation Resistance	≥5000MΩ(100VDC)
Input Resistance	380±10Ω	Cable	4-Wire Shielded Cable
Output Resistance	350±3Ω	Cable Length	3m
Temp.Effect on Output	±0.02%F.S/10℃	Ingress Protection	IP65
Temp.Effect on Zero	±0.02%F.S/10℃	Wiring Code	Exc+: Red Exc-: Black
Operating Temp.Range	-20~+65℃		Sig+: Green Sig-: White