

Column Load Cell

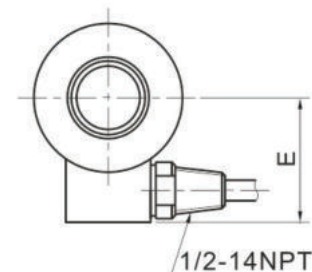

GCS703

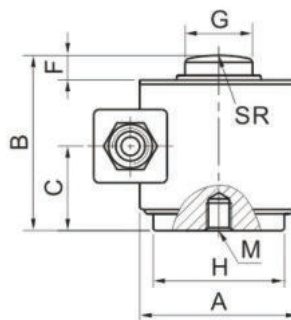

Rated Load		Size(mm)								M		
t	Klb	A	B	C	E	F	G	H	SR	Inch	mm	DP
5~20	10~50	75	83	32.5	64	10	31.8	62	125	1/2-20	M12*1.75	13
45	100	100.6	127	54.6	86	14	59	88.6	152	3/4-16	M20*1.5	18
90~180	200~400	150.6	184.5	92	108	26	80	134.4	400	3/4-16	M20*1.5	25
225	500	164	229	92	108	26	93.7	148	400	3/4-16	M20*1.5	25
450	1000	177	304.8	117	115	26	139.7	165.1	1143	3/4-16	M20*1.5	32

FEATURES

- Alloy steel body, covered with stainless steel material;
- Laser welding seal, protection grade IP68;
- Suitable for electronic truck scale, dynamic railroad scale and big capacity hopper scale, etc.

PARAMETER

Rated Load	5~450(t)		
Comprehensive Error	±0.02%F.S	Excitation, Recommended	10VDC
Rated Output	1.75 or 2.0±0.005mV/V	Excitation, Maximum	15VDC
Zero Balance	±1%F.S	Safe Overload	120%F.S
Creep	±0.02%F.S/30min	Ultimate Overload	300%F.S
Input Resistance	450±5Ω	Insulation Resistance	≥5000MΩ(50VDC)
Output Resistance	480±3Ω	Cable	4-Wire Shielded Cable
Temp.Effect on Output	±0.02%F.S/10℃	Cable Length	Φ6mm×9(12)m
Temp.Effect on Zero	±0.02%F.S/10℃	Ingress Protection	IP68
Compensated Temp.Range	-10~+40℃	Wiring Code	Exc+: Red Exc-: Black
Operating Temp.Rang	-20~+60℃		Sig+: Green Sig-: White