

# Weighing Transmitter

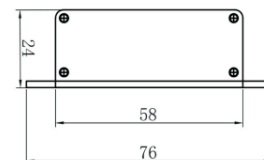

## GT203

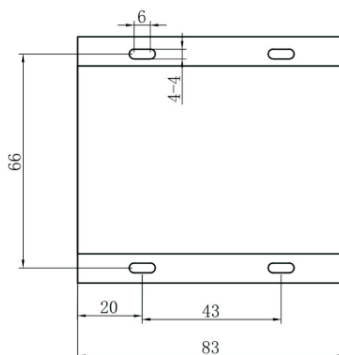
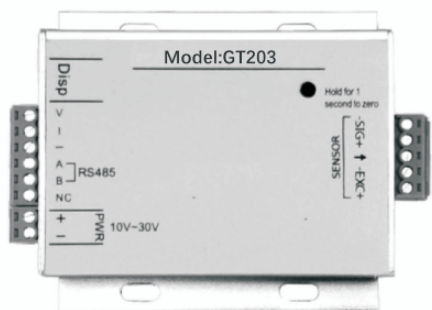

### FEATURES

1. Fast data transmission speed, 1280 times/second;
2. Output signal: RS232 or RS485 (standard), analog signal (optional);
2. The transmitter has a calibrator, which is more intuitive and convenient to set parameters and calibrate the sensor.

### SPECIFICATIONS

Input Sensitivity	0.4-6mV/V
Sensor Excitation Voltage	5VDC±2%, 100mA (up to 6 350Ω sensors can be connected)
Supply Voltage	10V~30VDC
Comprehensive Precision	1/10000
Rated Output	0-±10V, 0-±20mA, 4-20mA, Resolution 1/3000 (Analog output optional)
	RS232 connector, MODUBS RTUMODUBS RTU agreement and free agreement available (standard)
	Rs485 connector, up to 32 nodes can be connected, MODUBS RTU agreement and free agreement available (standard)
Sample Frequency	1280HZ
Operation Temperature	-30-+60℃
Protection Grade	IP65

### PRODUCT SELECTION

Model	Output	Model	Output
GT203-R2	RS232	GT203-R4	RS485
GT203-R2-V1	RS232+0~±10V	GT203-R4-V1	RS485+0~±10V
GT203-R2-A1	RS232+0~±20mA	GT203-R4-A1	RS485+0~±20mA
GT203-R2-A2	RS232+4~20mA	GT203-R4-A2	RS485+4~20mA