

Static Torque Sensor

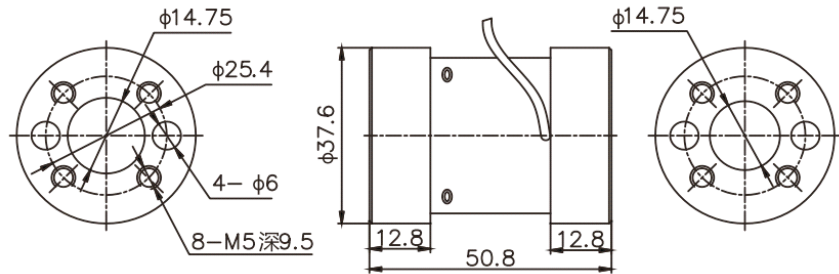

GTS303



FEATURES

1. Static torque sensor
2. Compact structure, easy to install
3. Protection grade: IP65
4. Used for static , non-continuous rotation torque measurement.

SPECIFICATIONS

Range	1, 2, 3, 5, 6, 10, 20, 30, 50, 100, 150N.M	Input resistance	410±20Ω
Comprehensive error	≤±0.1%, ±0.3%	Output resistance	350±10Ω
Sensitivity	1.5±10% mV/V	Insulation resistance	≥5000MΩ/100VDC
Zero balance	±2.0% F.S	Excitation voltage	9~15VDC
Non-linearity	0.1, 0.3% F.S	Compensated temp range	-10 ~ 60°C
Hysteresis	≤±0.05% F.S	Operating temp Range	-20 ~ 80°C
Repeatability	≤±0.05% F.S	Safe overload	120% F.S
Creep	≤±0.03% F.S/30min	Ultimate overload	150% F.S
Temp.effect on span	±0.05% F.S/10°C	Electrical connections	RED/E+, BLACK/E- GREEN/S+, WHITE/S-
Temp.effect on zero	±0.05% F.S/10°C		