

Static Torque Sensor

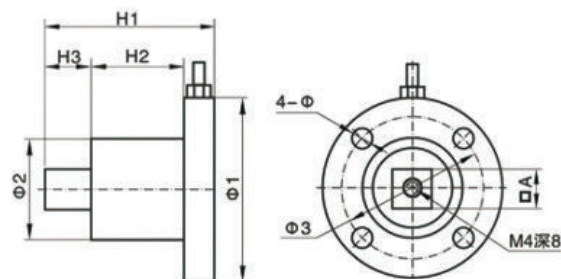

GTS301



Range	Size/mm							
	A	H1	H2	H3	Φ1	Φ2	Φ3	φ
N.m								
2~200	12.5	55	30	15	59	32	45	6.5
300~1500	25.4	75	40	24	68	40	55	8.5
2000~3000	25.4	85	44	24	98	56	80	13

FEATURES

Applicable to measure and control of the static, non-continuous rotation torque force value ;

APPLICATION

It is mainly used for testing system of testing machine and static torque test. Generally for testing the slow motion of torque, such as: Test manual torque wrench, transmission static load torque, etc., It is the basis of inspection and assembly quality in quality inspection department .

SPECIFICATIONS

Parameters:	
Torque range: 2~3000 (N.m)	Output resistance: 350±3Ω or 700±5Ω
Comprehensive error: 0.1~0.5%F.S	Insulation resistance: >5000MΩ
Rated output: 1.0~1.5mV/V	Safe overload: 150%F.S
Creep: ±0.05%F.S/30min	Excitation voltage: 10VDC
Zero output: ±1%F.S	Material: alloy steel
Temp. effect on zero: ±0.05%F.S/10℃	Wiring connection: Input +: red
Temp. effect on span: ±0.05%F.S/10℃	Input -: black
Use temp. Range: -20℃~+65℃	Output +: green
Input resistance: 380±10Ω or 750±15Ω	Output -: white