

Double Flange Static Torque Sensor GTS300

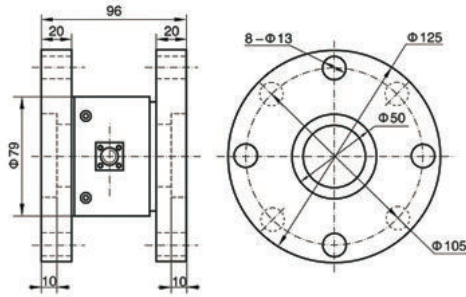

FEATURES

Double flange connection, easy installation;

Applicable to measure and control of the static, non-continuous rotation torque force value ;

APPLICATION

It is mainly used for testing system of testing machine and static torque test. Generally for testing the slow motion of torque, such as: Test manual torque wrench, transmission static load torque, etc., It is the basis of inspection and assembly quality in quality inspection department .

SPECIFICATIONS

Parameters:	
Torque range: 1000~5000 (N.m)	Output resistance: 350±3Ω or 700±5Ω
Comprehensive error: 0.1~0.5%F.S	Insulation resistance: >5000MΩ
Rated output: 1.0~2.0mV/V	Safe overload: 120%F.S
Creep: ±0.05%F.S/30min	Excitation voltage: 10VDC
Zero output: ±2%F.S	Material: alloy steel
Temp. effect on zero: ±0.05%F.S/10 C	Wiring connection: Input +: red
Temp. effect on span: ±0.05%F.S/10 C	Input -: black
Use temp. Range: -20 C~+65 C	Output +: green
Input resistance: 380±10Ω or 750±15Ω	Output -: white