

# Dynamic Torque Sensor

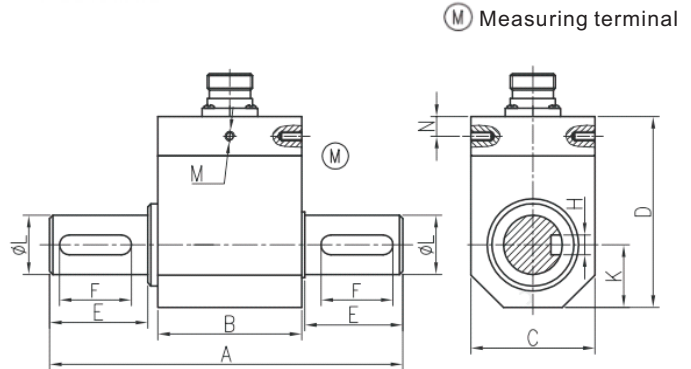

## GTS204



Range	A	φL	B	C	D	E	F	K	N	M	H
100N.M	108	18	44	38	58	30	22	19	6	3-M3	6
500N.M	143	28	56	53	73.5	40	30	27	6	2-M3	8
1000N.M	221	50	97	90	125	60	55	45	33	4-M4	16

### FEATURES

1. It is an integrated product composed of resistance strain gauge as sensing element and integrated circuit
2. High precision, stable and reliable performance
3. Medium/Large range torque measurement, output positive and negative torque signal, keyway connection at both ends.
4. Speed up to 1800 RPM.

### SPECIFICATIONS

Range	0~10, 20, 30, 50, 100, 200, 500, 1000N.M	Output resistance	700±5Ω
Sensitivity	1.5±10% $mV/V$	Insulation resistance	≥5000MΩ/100VDC
Zero balance	±2.0%F.S	Excitation voltage	5 ~ 12VDC
Non-linearity	0.1, 0.3%F.S	Compensated temp range	-10~60°C
Hysteresis	≤±0.05%F.S	Operating temp Range	-20~80°C
Repeatability	≤±0.05%F.S	Safe overload	150%F.S
Creep	≤±0.03%F.S/30min	Ultimate overload	200%F.S
Temp.effect on span	±0.03%F.S/10°C	Cable length	Φ5.2*3m
Temp.effect on zero	±0.03%F.S/10°C	Electrical connections	RED/E+, BLACK/E- GREEN/S+, WHITE/S-
Input resistance	750±10Ω		