

GML679

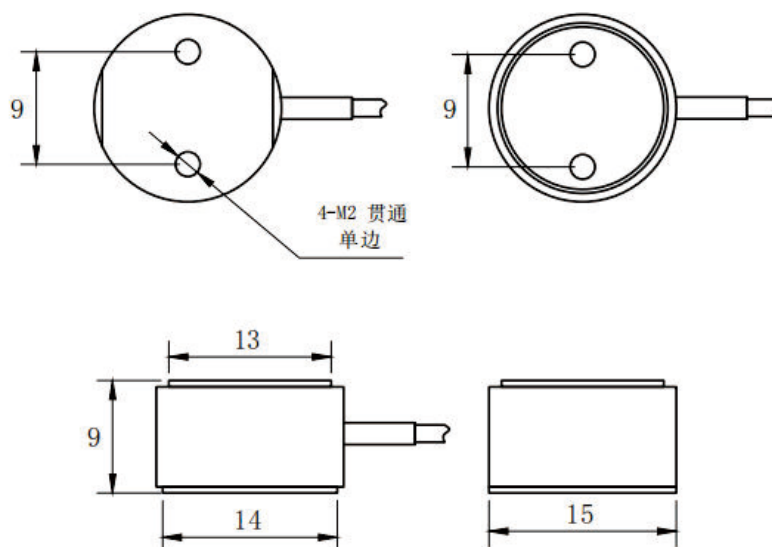
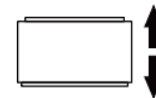

FEATURES

- Stainless steel, tension and compression ;
- Micro sensor, low height, small deformation, dynamic response frequency is high ;
- Mainly used for automobile manufacturing, medical equipment, robots, automation equipment, etc. Feel is testing for example: buttons, hot and cold press pressure Detection, machine hand holding power, etc.

PARAMETERS

Rated Load	5, 10, 20, 50, 100, 200(N)		
Comprehensive Error	$\leq \pm 0.1\% \text{F.S}$	Compensated Temp Range	$-10 \sim +60^{\circ}\text{C}$
Rated Output	$1.5 \pm 10\% \text{mV/V}$	Operating Temp Range	$-20 \sim +80^{\circ}\text{C}$
Zero Balance	$\pm 2.0\% \text{F.S}$	Excitation, Recommended	5 ~ 10V
Linearity Error	0.1% F.S	Safe Overload	200% F.S
Creep	$\pm 0.1\% \text{F.S}/30\text{min}$	Ultimate Overload	500% F.S
Input Resistance	$650/350 \pm 10\Omega$	Insulation Resistance	$\geq 5000 \text{M}\Omega (100 \text{VDC})$
Output Resistance	$650/350 \pm 10\Omega$	Ingress Protection	IP66
Temp. Effect on Span	$\pm 0.05\% \text{F.S}/10^{\circ}\text{C}$	Wiring Code	Exc+ : Red Exc- : Black
Temp. Effect on Zero	$\pm 0.05\% \text{F.S}/10^{\circ}\text{C}$		Sig+ : Green Sig- : White