

Tension / Compression Force Sensor

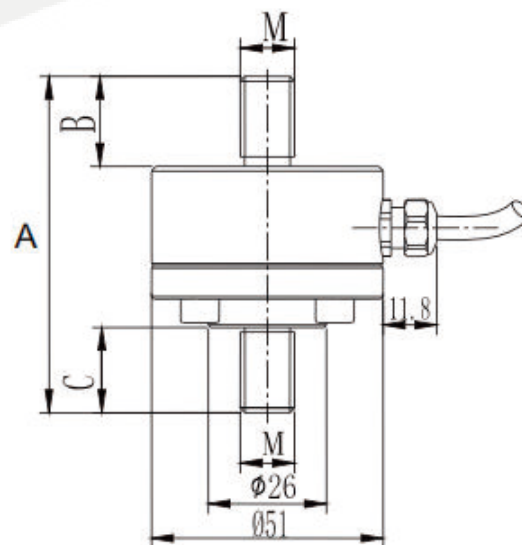

GML668E

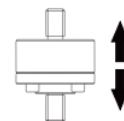

Rated Load		Size(mm)			
kN	t	A	B	C	D
1,2,3,5,10,20	0.1,0.2,0.3,0.5,1,2	71	19	18	M12
30,50	3,5	86	25	25	M16

FEATURES

- Stainless steel,tension and compression ;
- Miniature load cell with metal foil strain gauge technology ;
- Suitable for force measurement in limited spaces,widely used for automatic assembly test, Medical inspection,robotics and various industrial automation strain field.

PARAMETERS

Rated Load	1,2, 3, 5, 10, 20,30, 50(kN)		
Comprehensive Error	$\leq \pm 0.2\%F.S$	Compensated Temp Range	-10~+60℃
Rated Output	1.5±10% mV/V	Operating Temp Range	-20~+80℃
Zero Balance	±2.0% $F.S$	Excitation,Recommended	5~15V
Linearity Error	0.2% $F.S$	Safe Overload	150% $F.S$
Creep	±0.05% $F.S/30min$	Ultimate Overload	200% $F.S$
Input Resistance	700±10Ω	Insulation Resistance	≥5000MΩ(100VDC)
Output Resistance	700±10Ω	Ingress Protection	IP66
Temp. Effect on Span	±0.05% $F.S/10℃$	Wiring Code	Exc+ : Red Exc- : Black
Temp. Effect on Zero	±0.05% $F.S/10℃$		Sig+ : Green Sig- : White