

GML668B

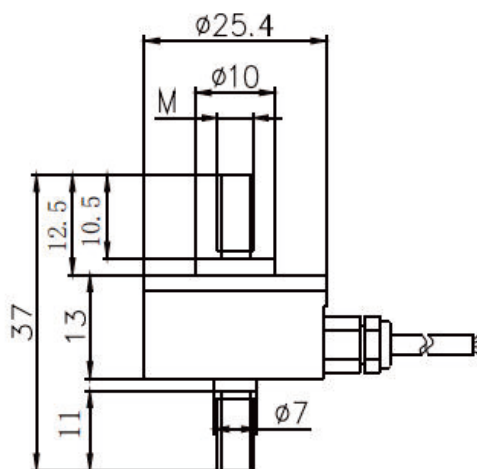
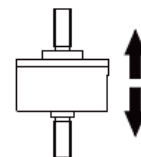

FEATURES

- Stainless steel, two-way tension and compression :
- The product is mainly special used for automotive pressure equipment, automated assembly, 3C product testing, new energy, medical testing, product assembly robot, mold assembly, and other areas of the industrial automation field.

Rated Load		Size(mm)
N	kg	M
50, 100, 200, 300, 500	5, 10, 20, 30, 50	M5
1000	50, 100	M6

PARAMETERS

Rated Load	50, 100, 200, 300, 500, 1000(N)		
Comprehensive Error	$\leq \pm 0.1\% \text{F.S}$	Compensated Temp Range	-10~+60℃
Rated Output	2.0±10% mV/V	Operating Temp Range	-20~+80℃
Zero Balance	±2.0% F.S	Excitation, Recommended	5~15V
Linearity Error	0.1% F.S	Safe Overload	150% F.S
Creep	±0.05% F.S/30min	Ultimate Overload	200% F.S
Input Resistance	700±10Ω	Insulation Resistance	≥5000MΩ(100VDC)
Output Resistance	700±10Ω	Ingress Protection	IP66
Temp. Effect on Span	±0.05% F.S/10℃	Wiring Code	Exc+ : Red Exc- : Black
Temp. Effect on Zero	±0.05% F.S/10℃		Sig+ : Green Sig- : White