

# Compression Force Sensor

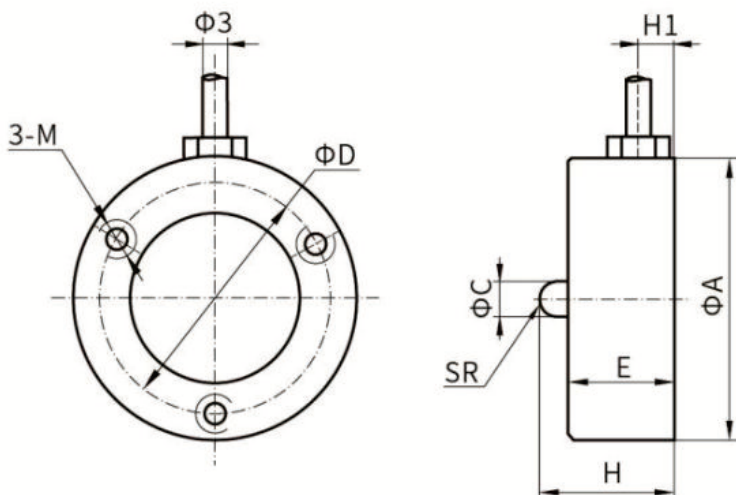

## GML669

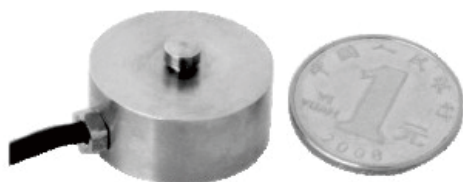
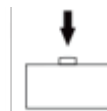

Rated Load		Size(mm)							
kN	kg	Φ A	Φ C	Φ D	H	E	M	H1	SR
0.1~2	10~200	20	2.5	15.5	12	10	M3	3.5	6
3~10	300~1000	26	5	18.5	15	11.5	M4	3.5	6
20	2000	30	6	20	18	14	M4	3.5	15

### FEATURES

- Stainless steel materials;
- The product is mainly suitable for force measurement occasions with limited space.

### PARAMETERS

Rated Load	0.1,0.2,0.3,0.5,1,2,3,5,10,20(kN)		
Comprehensive Error	±0.5%F.S	Operating Temp Range	-20℃~+65℃
Rated Output	1.0~1.5mV/V	Excitation,Recommended	10VDC
Zero Balance	±1%F.S	Safe Overload	150%F.S
Creep	±0.05%F.S/30min	Ultimate Overload	200%F.S
Input Resistance	350±20Ω	Insulation Resistance	≥5000MΩ(100VDC)
Output Resistance	350±3Ω	Ingress Protection	IP66
Temp. Effect on Span	±0.05%F.S/10℃	Wiring Code	Exc+ : Red Exc- : Black
Temp. Effect on Zero	±0.05%F.S/10℃		Sig+ : Green Sig- : White